

TECHNICAL DATA | GENERAL PURPOSE |

ZR304A Series

Work Material	Carbon Steels, Alloy Steels, Cast Iron		Alloy Steels, Tool Steels		Stainless Steels		Hardened Steels		Hardened Steels	
Hardness	≤ 30 HRc		30 ~ 40 HRc		-		45 ~ 55 HRc		55 ~ 65 HRc	
Strength	~ 145,038lbf / inch ²		145,038 ~ 217,557lbf / inch ²		-		217,557 ~ 290,076lbf / inch ²		290,076lbf / inch ²	
Cutting Diameter(inch)	RPM	FEED	RPM	FEED	RPM	FEED	RPM	FEED	RPM	FEED
1/16	11,560	11.0	7,560	6.7	6,300	5.5	5,040	2.0		
1/8	8,920	12.6	5,560	7.9	4,620	6.7	3,360	2.4	1,900	2.4
3/16	6,300	23.6	3,780	14.2	3,160	11.8	2,320	2.8	1,260	2.4
1/4	5,560	26.0	3,360	16.2	2,840	13.0	2,000	3.2	1,100	2.4
5/16	4,200	28.0	2,520	15.0	2,100	13.8	1,680	4.3	840	2.4
3/8	3,260	24.0	2,000	11.8	1,680	11.8	1,360	3.6	680	2.0
1/2	2,740	20.5	1,680	9.9	1,360	9.5	1,160	3.2	560	2.0
5/8	2,200	16.2	1,360	7.9	1,060	7.9	900	2.4	440	1.2
3/4	1,680	12.6	1,060	6.3	840	5.9	680	1.6	320	1.2
1	1,360	9.9	840	5.1	680	4.7	540	1.2	260	0.8

RPM = rev. / min.
FEED = inch / min.

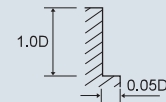
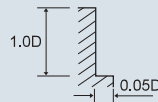

GENERAL PURPOSE > INCH