

TECHNICAL DATA | WINNER |

WR542 Series

Work Material	Alloy Steels, Carbon Steels (SCM, SNCM, S45C)		Prehardened Steels (NAK, CENA, KP4)		Hardened Steels (SKD, SKT, STAVAX)	
Hardness	≤ 35 HRc		35 ~ 45 HRc		45 ~ 55 HRc	
Strength	≤ 1100N / mm ²		1100~1500N / mm ²		1500~2000N / mm ²	
Cutting Diameter (metric)	RPM	FEED	RPM	FEED	RPM	FEED
0.2	50,000	170	34,500	75	21,150	45
0.3	50,000	200	32,000	85	20,000	50
0.4	50,000	200	32,000	85	20,000	50
0.5	43,000	220	28,000	95	17,100	60
0.6	36,400	250	24,000	110	14,500	65
0.8	36,400	250	24,000	110	14,500	65
1.0	33,100	280	21,600	120	13,200	70
1.5	26,400	300	16,200	130	10,200	70
2.0	21,600	310	13,800	140	8,640	80
2.5	18,000	320	11,400	150	7,320	80
3.0	15,900	330	10,300	160	6,300	80
4.0	12,800	400	8,200	200	5,150	95
5.0	11,000	500	7,000	240	4,560	120
6.0	9,500	600	6,000	300	3,930	140
8.0	7,200	640	4,550	300	3,020	140
10.0	6,000	640	4,000	300	2,420	140
12.0	5,000	500	3,340	270	2,000	120
16.0	3,720	450	2,520	210	1,540	95
20.0	3,000	330	1,950	140	1,200	70

RPM = rev. / min.
FEED = mm / min.

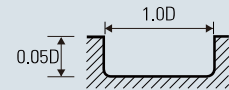
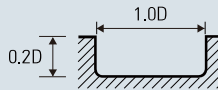

WR544 Series

Work Material	Alloy Steels, Carbon Steels (SCM, SNCM, S45C)		Prehardened Steels (NAK, CENA, KP4)		Hardened Steels (SKD, SKT, STAVAX)	
Hardness	≤ 35 HRc		35 ~ 45 HRc		45 ~ 55 HRc	
Strength	≤ 1100N / mm ²		1100~1500N / mm ²		1500~2000N / mm ²	
Cutting Diameter (metric)	RPM	FEED	RPM	FEED	RPM	FEED
1.0	33,100	360	21,600	260	13,200	140
1.5	26,400	370	16,200	270	10,200	140
2.0	21,600	380	13,800	280	8,640	150
2.5	18,000	390	11,400	300	7,320	150
3.0	15,900	400	10,300	310	6,300	150
4.0	12,800	500	8,200	360	5,150	160
5.0	11,000	510	7,000	430	4,560	200
6.0	9,500	510	6,000	430	3,930	200
8.0	7,200	550	4,550	430	3,020	200
10.0	6,000	550	4,000	430	2,420	200
12.0	5,000	430	3,340	380	2,000	160
16.0	3,720	330	2,520	280	1,540	135
20.0	3,000	270	1,950	210	1,200	100

RPM = rev. / min.
FEED = mm / min.

